

# BLUEPRINT. STRICTLY CONFIDENTIAL DOCUMENTS

## Interactive Projection Mapping on Modular Structure

### "TERRA V.2"

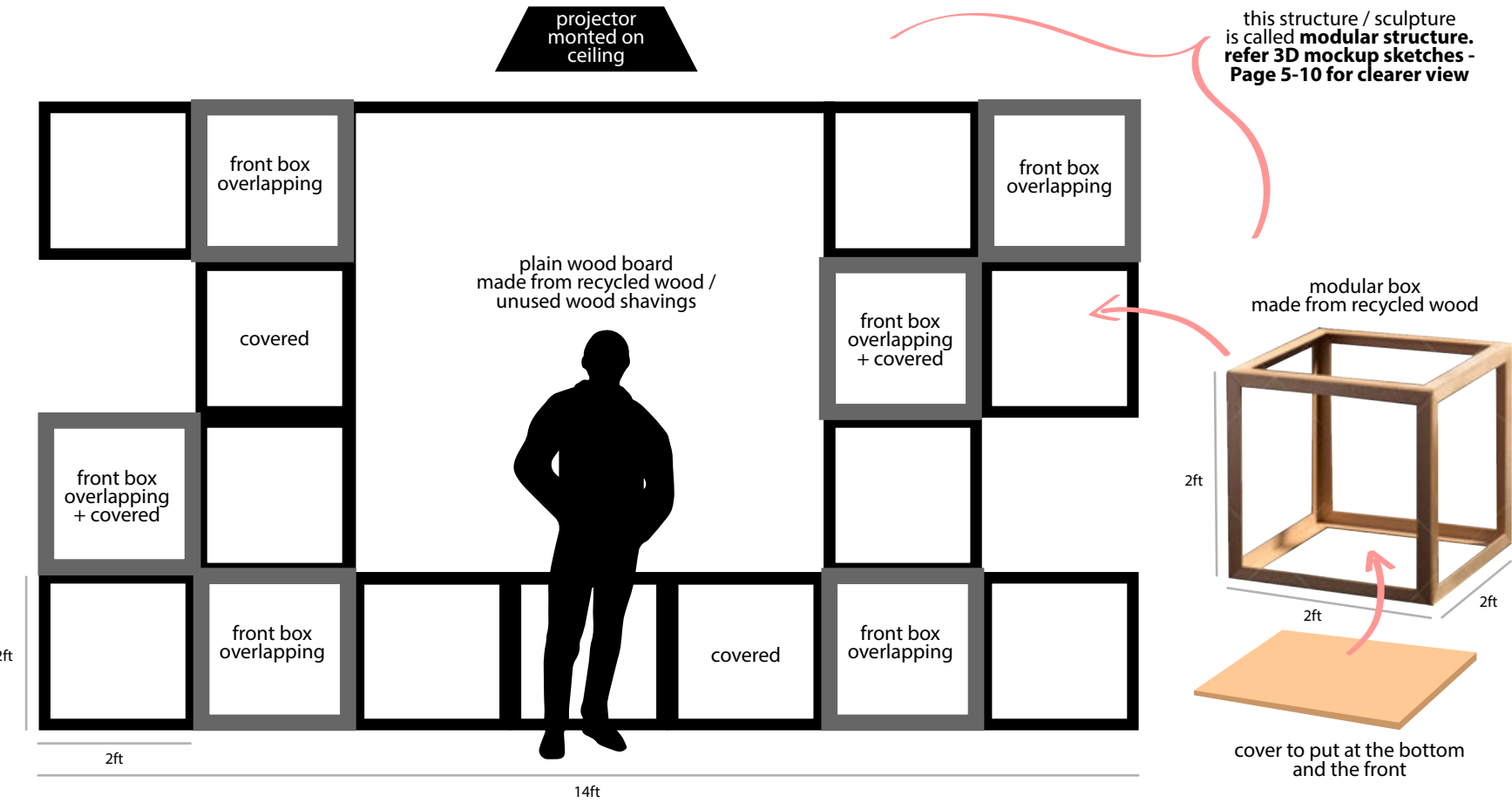

this structure / sculpture is called **modular structure**. refer 3D mockup sketches - Page 5-10 for clearer view

References:



1. Plant-In City by Huy Bui, Carlos Gomez, Jon Schramm  
[www.kickstarter.com/projects/plantincity/plant-in-city-architecture-and-technology-for-plan](http://www.kickstarter.com/projects/plantincity/plant-in-city-architecture-and-technology-for-plan)  
 Living, modular, sculptural 21st century terrariums for discovering new ways to interact with plants.

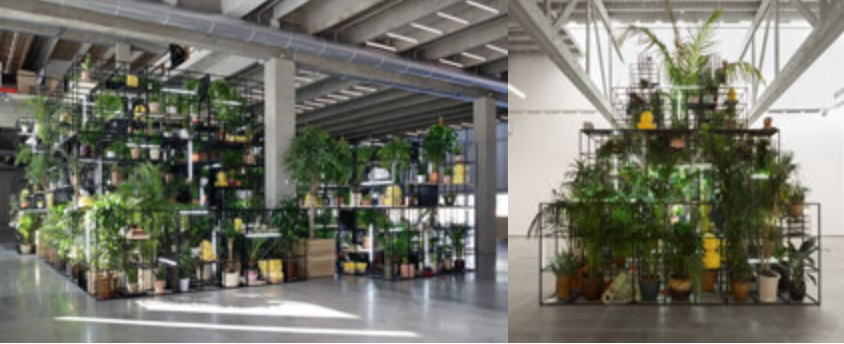

1. "Within Our Gates" & "Islands" by Rashid Johnson  
[www.davidkordanskygallery.com/exhibition/islands/#press](http://www.davidkordanskygallery.com/exhibition/islands/#press)  
[www.garagemca.org/en/exhibition/rashid-johnson-within-our-gates](http://www.garagemca.org/en/exhibition/rashid-johnson-within-our-gates)  
 Constructed as a maze-like environment for all the senses, Within Our Gates integrates tropical plants such as palms, dracaenas, ficus, and ferns, with sculptural elements, moving image, sound, and everyday objects to immerse the viewer in the artist's poetic manifestation of a world where fictions and facts, histories and speculations converge. His first project in Russia, this is also the largest work the artist has ever made.

#### Statement:

### "TERRA V.2"

Continuing from its first version, Terra V.2 is a combination of Audiovisual Performance practice, projection mapping, and urban indoor garden design into one piece. In conjunction of promoting the sustainability development effect, we are using recycled shredded woods to build the main structure of this work, along with using visuals and sounds that promotes nature. Terra V.2, like its previous purposes, intend to create life and nature plants in urban areas by implementing contemporary gardening designs, and contemporary technology in fast-developing areas.

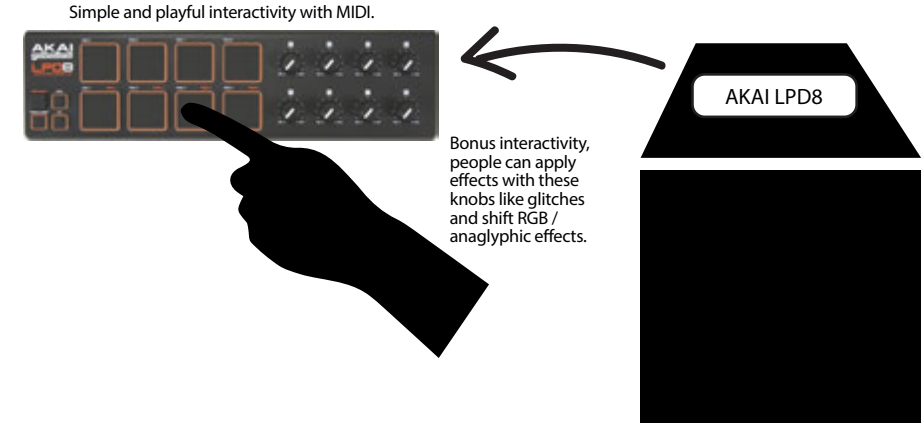

- Equipment:
1. 2 projectors of at least 2.5k lumens, 1 mounted on ceiling, 1 on the ground.
  2. HDMI cable
  3. Laptop
  4. AKAI LPD8
- Materials for wooden modular structure:
1. Recycled wood / recycled shredded wood
  2. Screws, and connectors

# BLUEPRINT. STRICTLY CONFIDENTIAL DOCUMENTS

## Interactive Projection Mapping on Modular Structure

### "TERRA V.2"

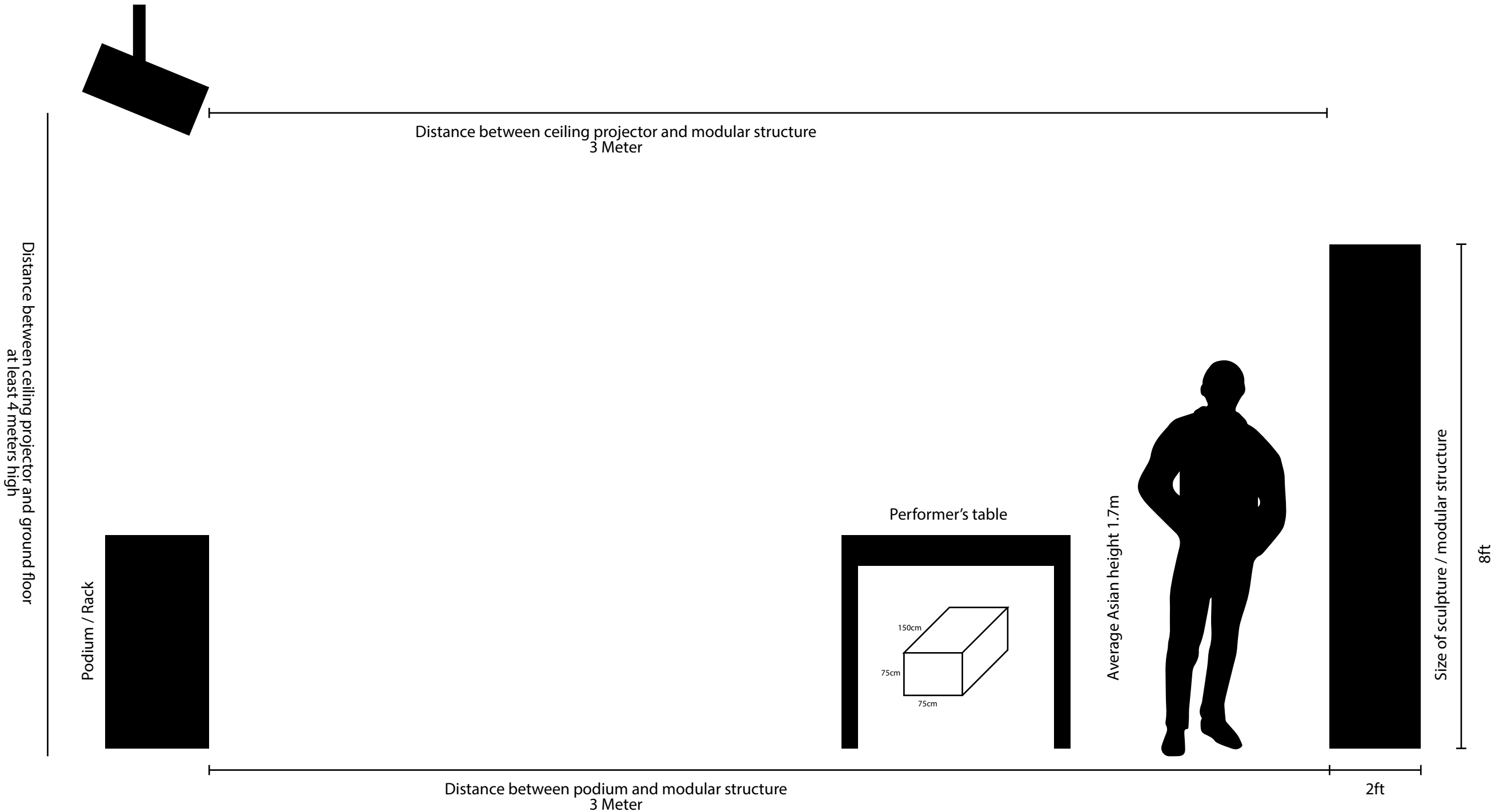

# BLUEPRINT. STRICTLY CONFIDENTIAL DOCUMENTS

## Interactive Projection Mapping on Modular Structure

### "TERRA V.2"

#### Technical Setup

1. Laptop with at least i7 processor, 4gb graphic card, 120gb SSD, and 4gb RAM
2. 2 Short-Throw FullHD Projector 3000 Lumens and above
3. FullHD Widescreen visual 16:9
4. 2 HDMI cable
5. Projector Ceiling mount
6. MIDI Akai LPD8 for simple interaction
7. Extension plug with at least 5 sockets
8. Resolume 4 and above
9. Must use "Advance Display" NOT "Display 2"
10. Make sure all visuals have converted to .mov format.  
Codec must be DXV3 for maximum smoothness.

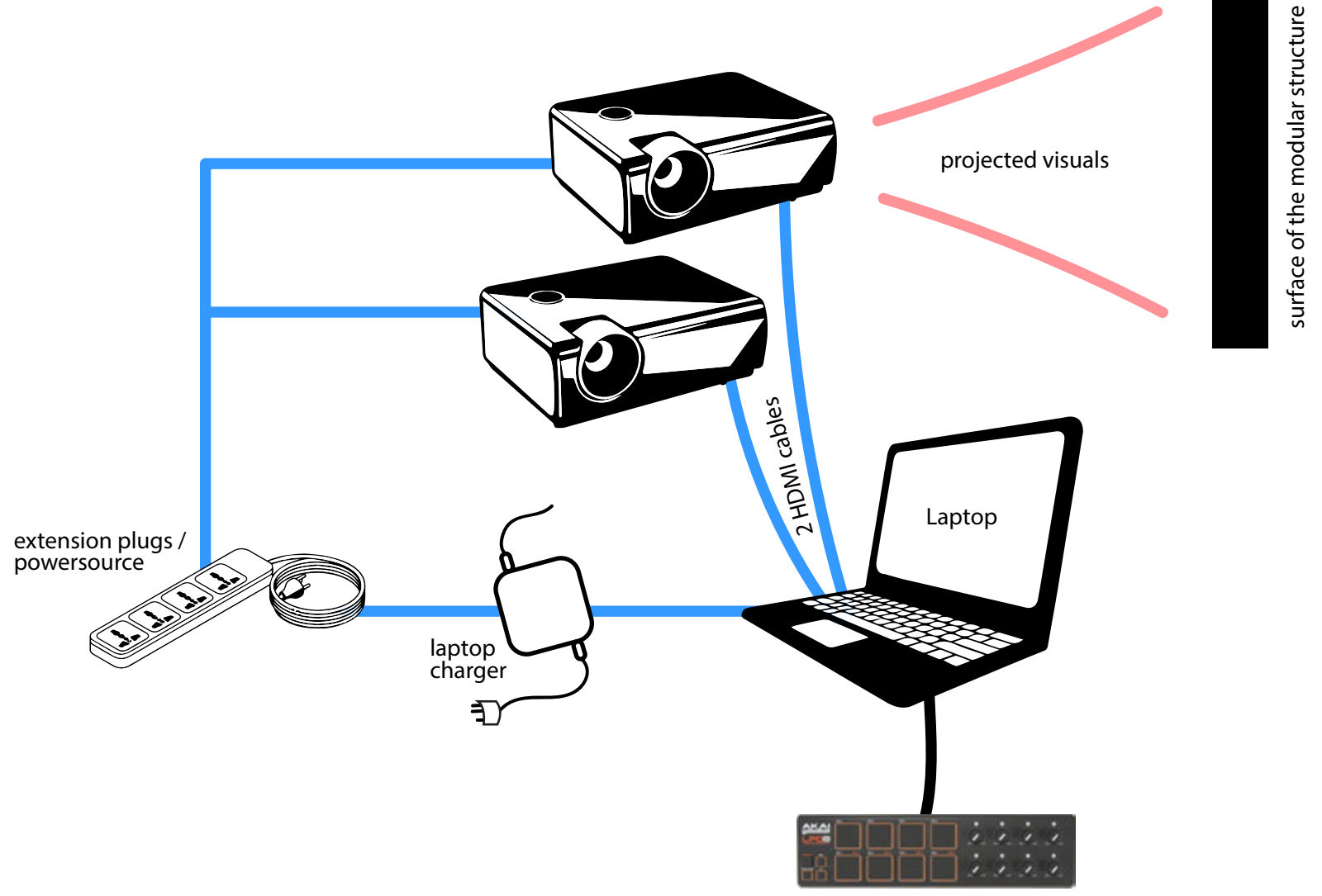
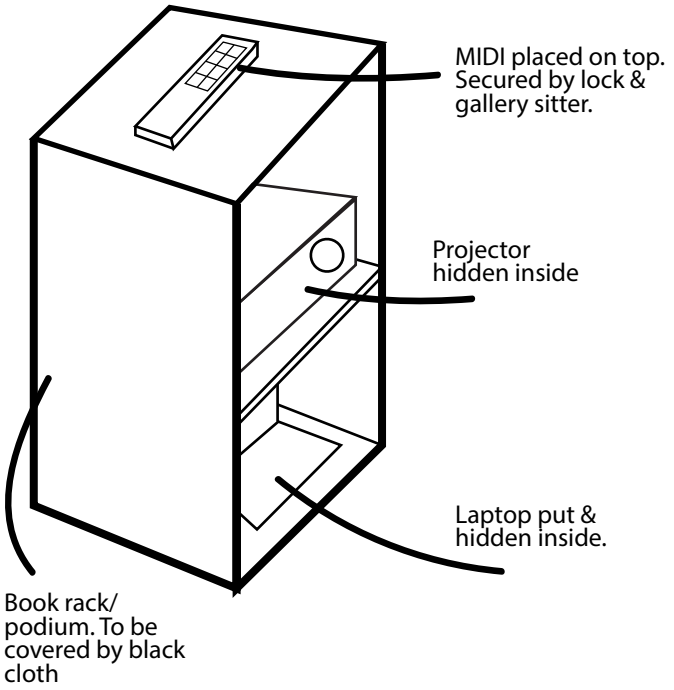

# BLUEPRINT. STRICTLY CONFIDENTIAL DOCUMENTS

## Interactive Projection Mapping on Modular Structure

### "TERRA V.2"

#### Building Instruction

##### Pre-Production

1. Make modular frame cubes
2. Make visuals & music
3. Call for collaborators (e.g: performers, assistant, motion graphic artists)
4. Site visit for measurement
5. Site visit for troubleshooting
6. Survey Plants
7. Program visuals and interactions

##### Production

1. Transfer modular cubes
2. Transfer plants
3. Setup modular structure
4. Setup plants
5. Setup and mount projectors
9. Setup podium and laptop
10. Project map visuals
11. Setup interaction
12. Setup soundsystem (all system in standby for performances)
13. Clean up wires and tidy up everything

When it is performing time, setup performer's table, setup wiring, and standby plug-ins.

##### Pre-Production

1. Clean up everything (using Production steps backward)
2. Transfer everything back to base
3. Documentation for portfolio (videos, photos, press)
4. Release media

#### Tentative Budget for 30 days of exhibition

1. 2 Short-throw FullHD Projector	RM7000
2. Ceiling Mount + Wiring	RM1000
3. Laptop	RM4000
4. HDMI cables	RM200
5. Modular Structure	RM8000
6. Plants	RM1000
7. Logistics	RM1000
8. MIDI AKAI LPD8	RM200
9. Labour and expertise (artists, collaborators, etc.) fee	RM6000

#### Tentative Budget for 3 days of Performance

1. Soundsystem	RM3000
2. Performers	RM6000
3. Volunteers Crew	RM1000

#### TOTAL

**RM38,400**

